

PLAN SHOWING THE SEWAGE LINE OF THE G+III STORED RESIDENTIAL BUILDING OF M/S ASTHA CONSTRUCTION (BISWANATH MAJUMDER, DWIJADAS MAJUMDER) AT MOUZA - RAJPUR, J.L NO.- 55, R.S & L.R DAG NO.- 253, R.S KHATIAN NO.- 1524,321, L.R KHATIAN NO.- 4240. HOLDING NO.- 29 K.C DUTTA ROAD, WARD NO.- 17 UNDER RAJPUR - SONARPUR MUNICIPALITY, P.S - SONARPUR, DIST.- SOUTH 24 PARGANAS, KOL.- 700149. SCALE - 1 :100.

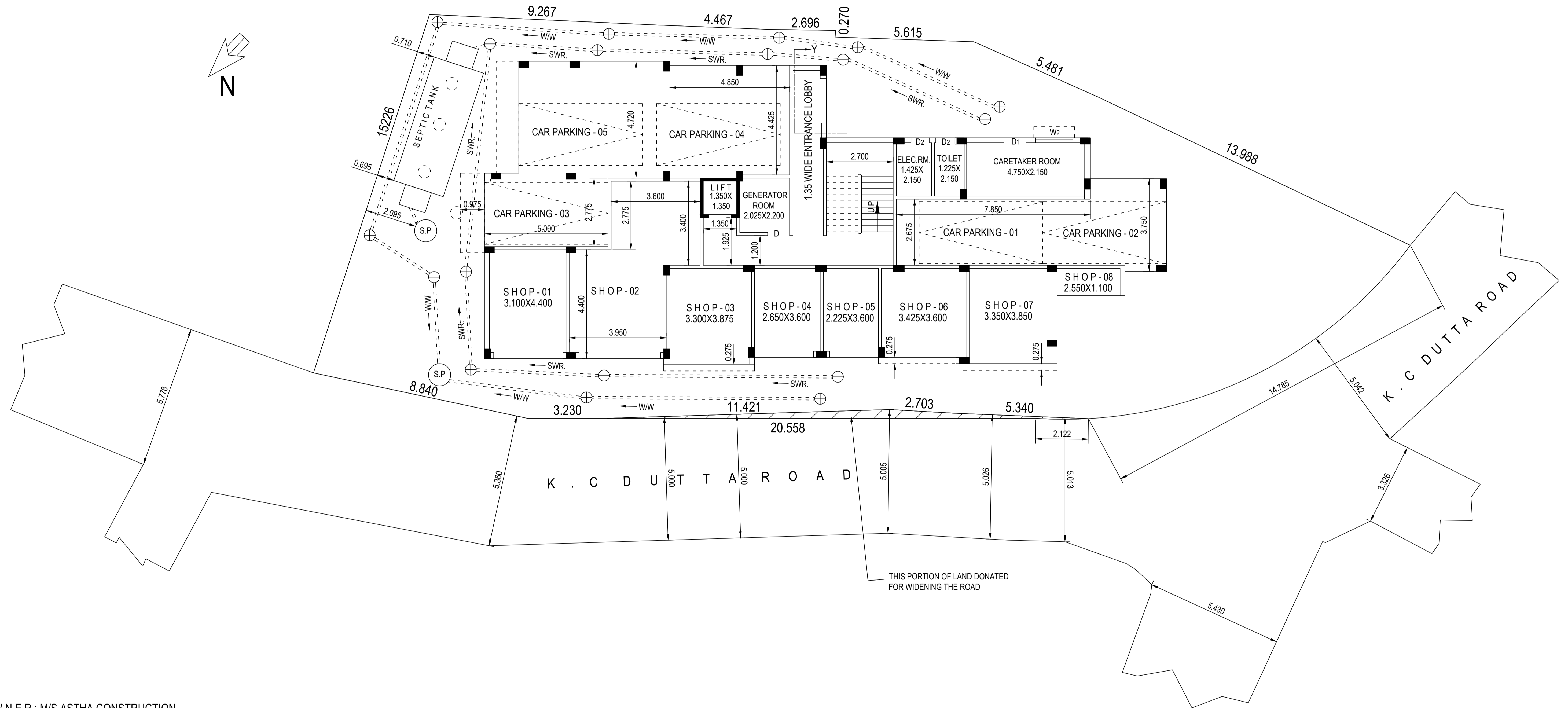

O W N E R : M/S ASTHA CONSTRUCTION

BISWANATH MAJUMDER :

DWIJADAS MAJUMDER :

CONSULTANT : JIT CHAKRABORTY

